

Part #: REL- Rev:  
File: REL025-assembly  
Desc.:  
Proj:  
Client:  
Mat:  
Finish:  
Qty:

Drawing Property of MSKCC  
Contact: Robert Roorda  
(212) 639-3212, Fax (646)422-2271

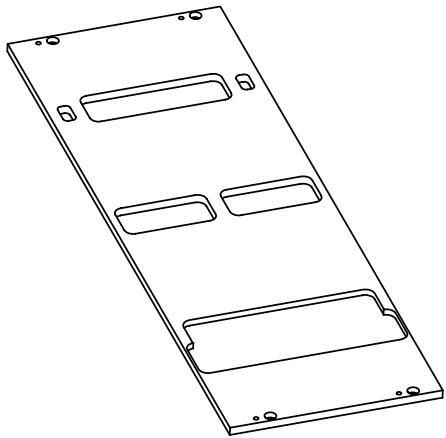

Ø 3.18 THRU  
(Loose fit for 1/8"  
dowel pin)

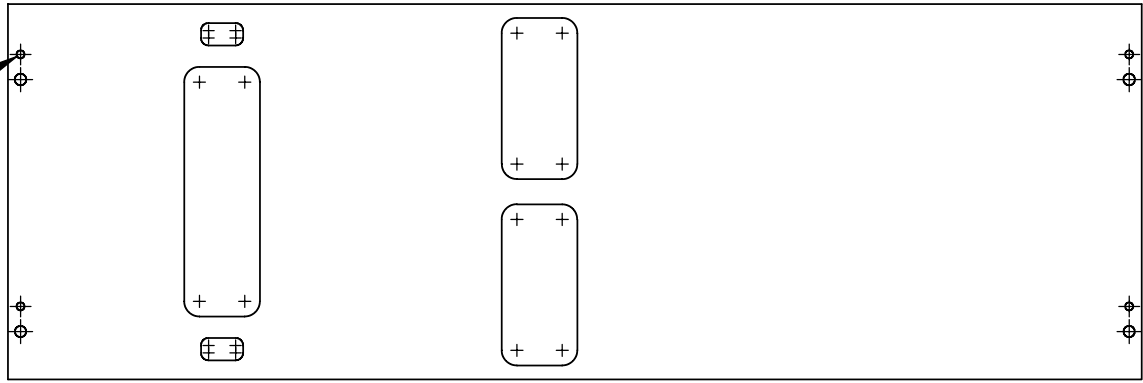

6<sup>+0.5</sup>  
0

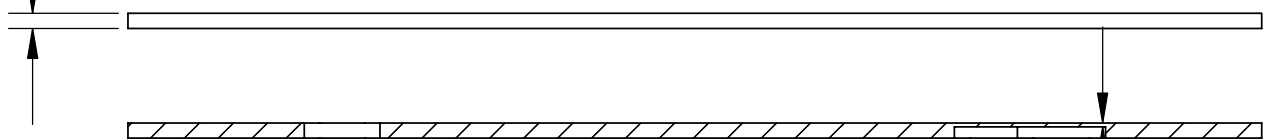

SECTION B-B  
SCALE 1 : 3

1.50±0.1

1.50±0.5

Ø 4.50 THRU  
└─┬─┘ Ø 7.94 ▽ 4.17  
(CBore for 8-32)

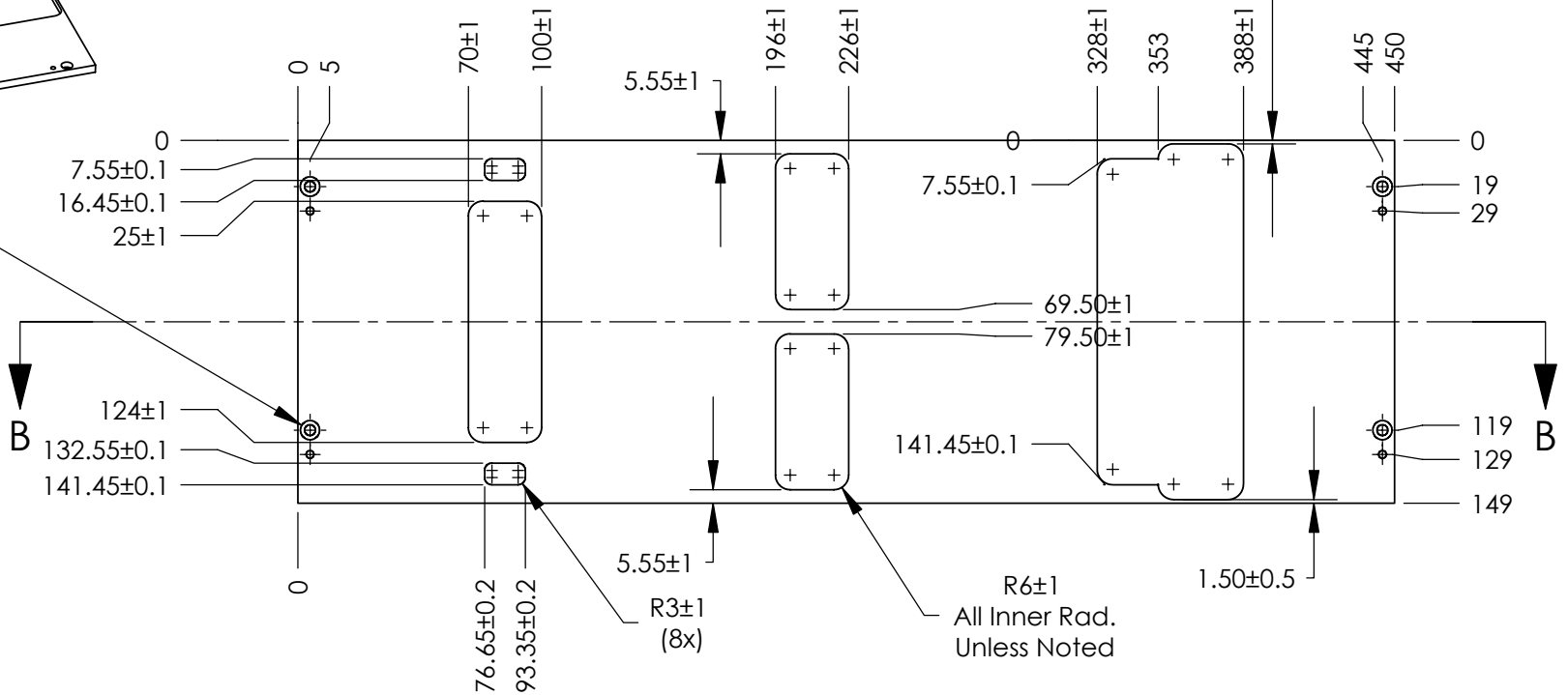

Part #: REL025-01 Rev: A

File: REL025-01-Base  
Desc.: Base Plate  
Proj: Alliquoting  
Client: Tempst  
Mat: Aluminum  
Finish: Clear Anodize  
Qty: 1

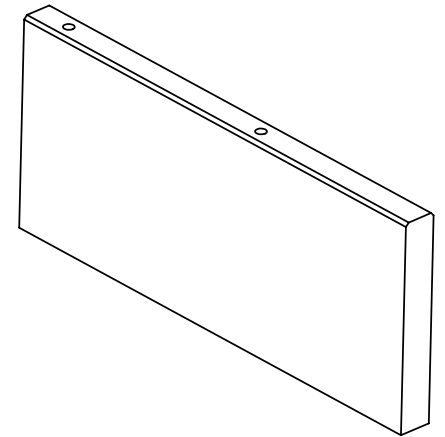
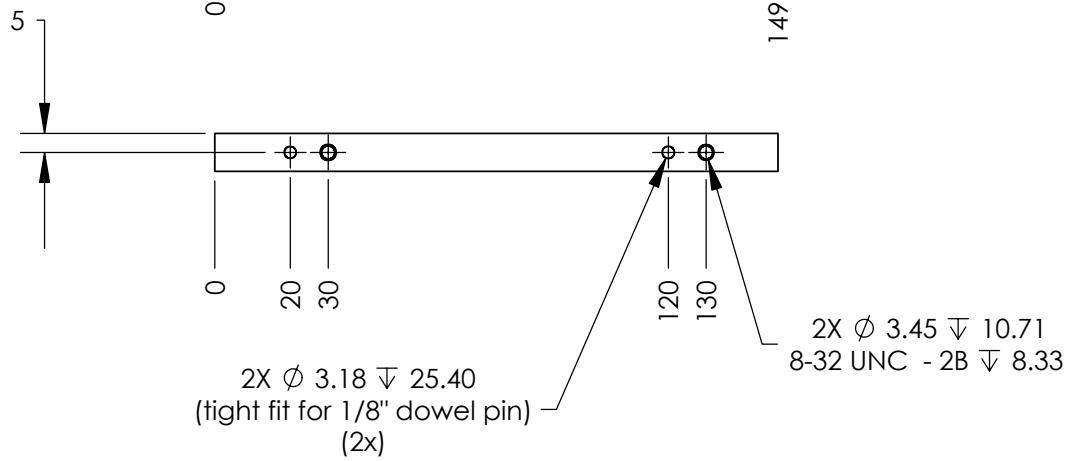
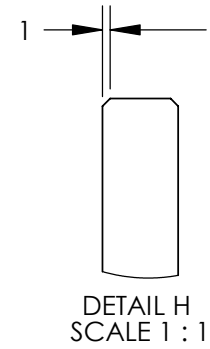
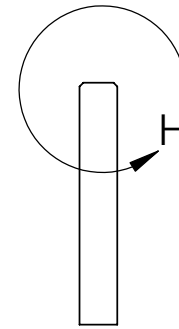
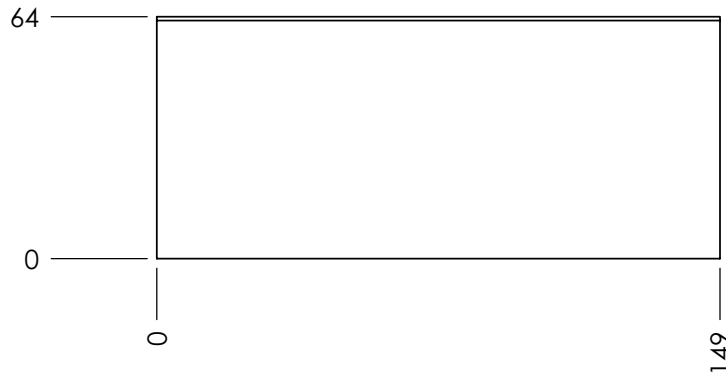
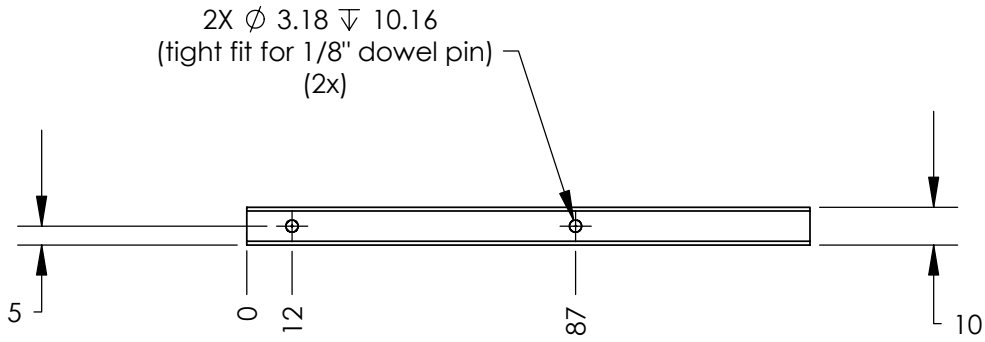

Part #: REL025-02 Rev: A

File: REL025-02-RackEnd  
 Desc.: Rack End Block  
 Proj: Alliquoting  
 Client: Tempst  
 Mat: Aluminum  
 Finish: Clear Anodize  
 Qty: 2

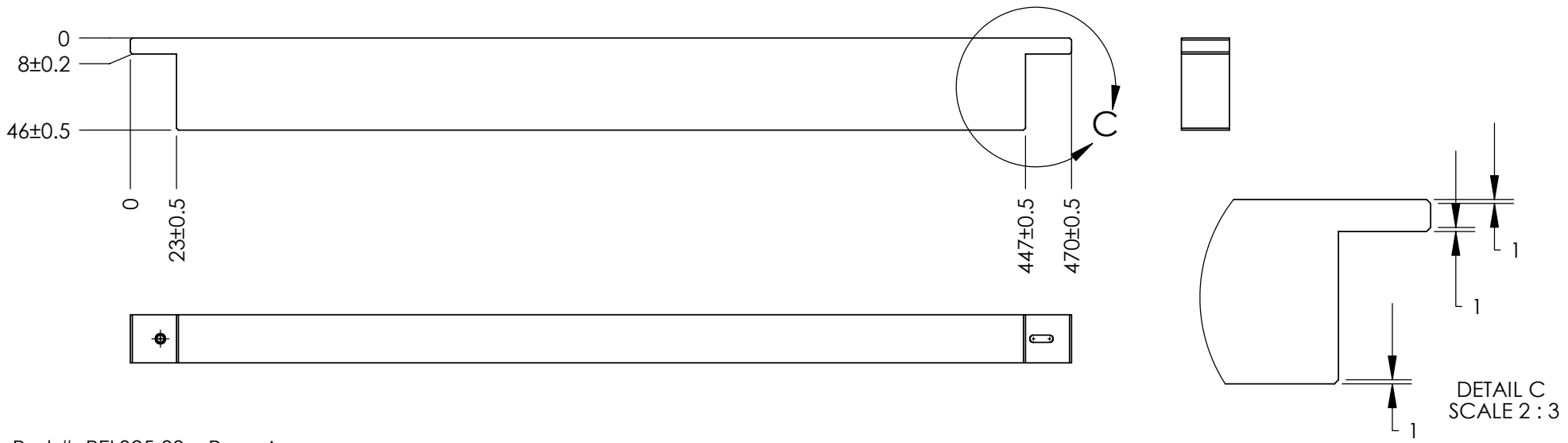
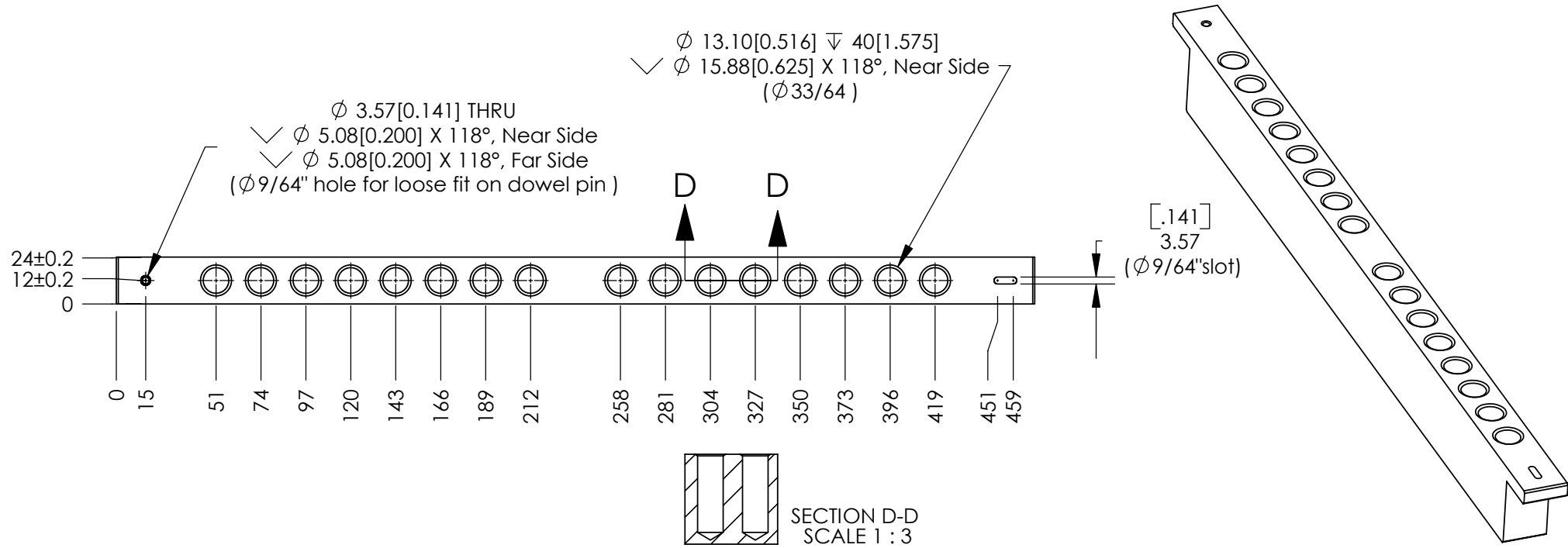

Part #: REL025-03 Rev: A

File: REL025-03-SourceRack  
 Desc.: Rack for Source Vials  
 Proj: Alliquoting Rack  
 Client: Tempst  
 Mat: Aluminium  
 Finish: Clear Anodize  
 Qty: 1

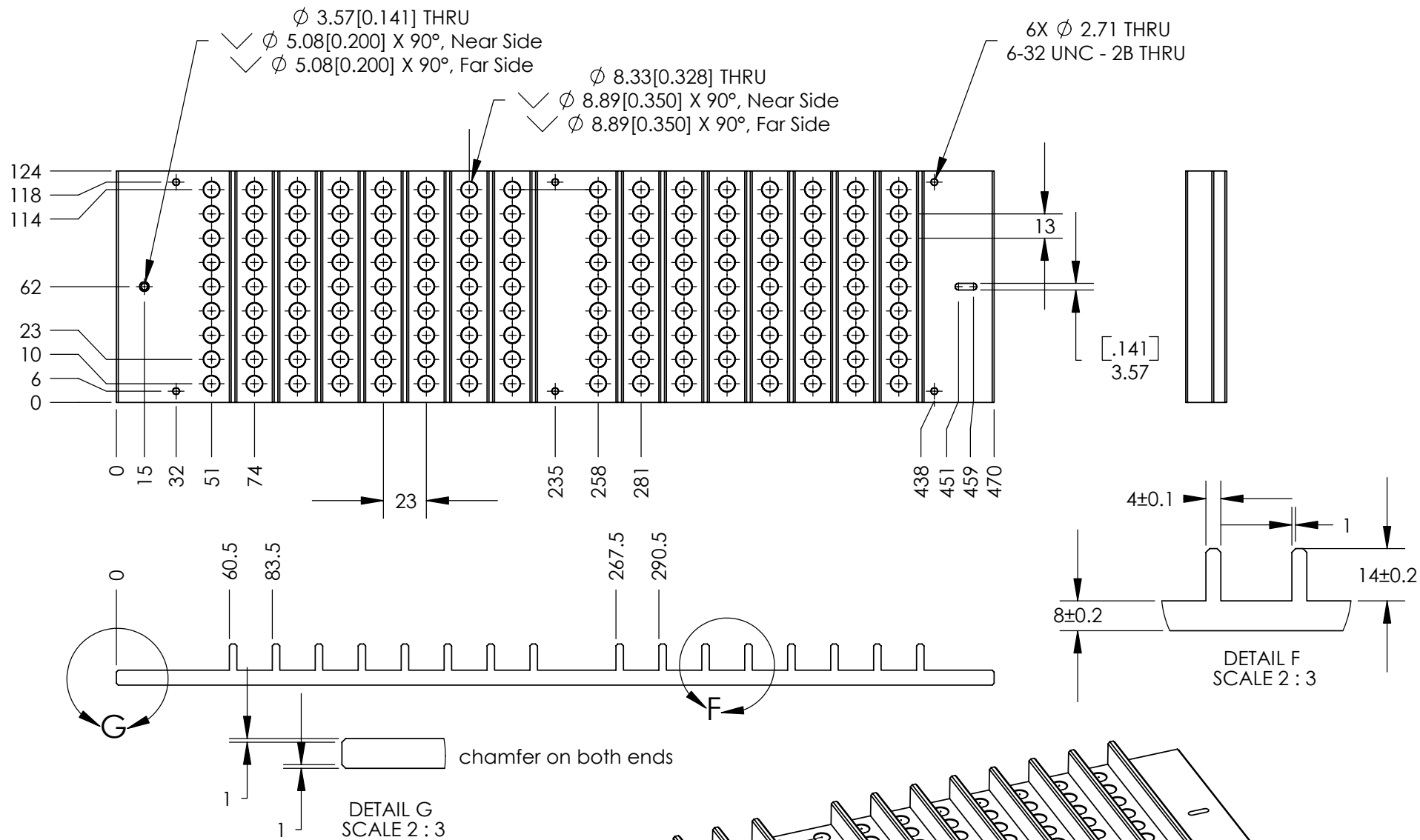

Part #: REL025-04 Rev: A

File: REL025-04-AlliquotRack  
 Desc.: Rack for Alliquots  
 Proj: Alliquoting Rack  
 Client: Tempst  
 Mat: Aluminium  
 Finish: Clear Anodize  
 Qty: 1

