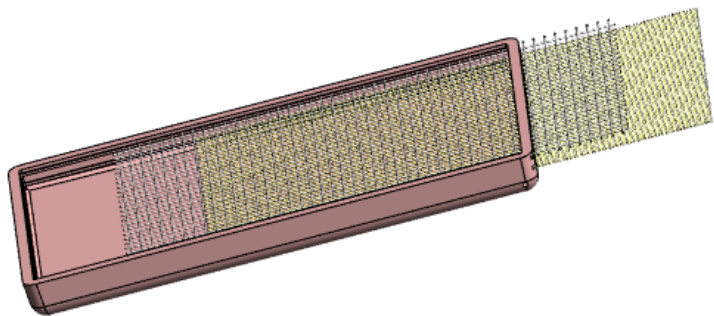

Fig. S1 Custom cage insert designed to separate urine and feces in diet trials. A) Close-up of the custom insert showing two screens. The first screen allows both urine and feces to fall through. The second screen only allows urine to fall through. Inserts incorporated a funnel design so that urine would pool to one corner of the floor for easy collection and to help prevent contamination. B) The insert as it appears inside the mouse cage.

A)



B)

